

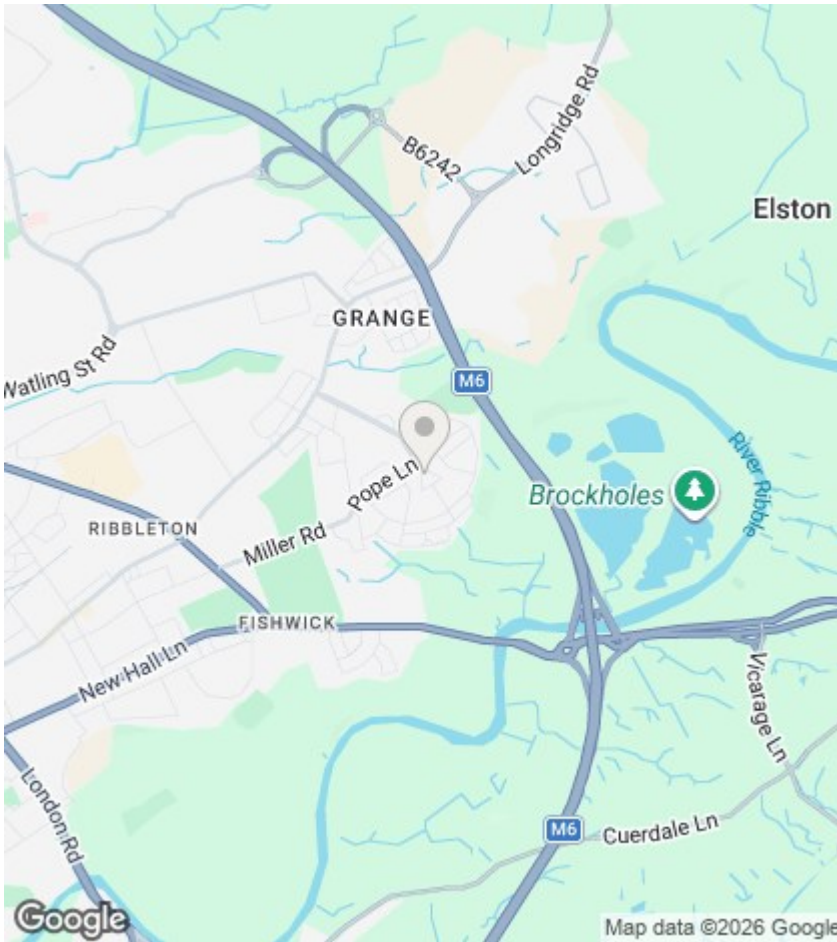

1 Woodacre Road, Ribbleton, Preston, PR2 6HS

£125,000

- Driveway
- Open Plan Kitchen/Dining Area
- Double Glazed
- Modern Boiler/Heating System
- Close To Local Ammenities
- EPC Grade C



Viewings:

Viewings by arrangement only.
Call 01772 888887 to make an appointment.

Meet the Agent:

A
Beth Nixon
sales@jonescameron.com

| Energy Efficiency Rating | | Current | Potential |
|---|--|-------------------------|-----------|
| Very energy efficient - lower running costs | | | |
| (92 plus) A | | | |
| (81-91) B | | | |
| (69-80) C | | | |
| (55-68) D | | | |
| (39-54) E | | | |
| (21-38) F | | | |
| (1-20) G | | | |
| Not energy efficient - higher running costs | | | |
| England & Wales | | EU Directive 2002/91/EC | |

Approx Gross Internal Area
53 sq m / 569 sq ft

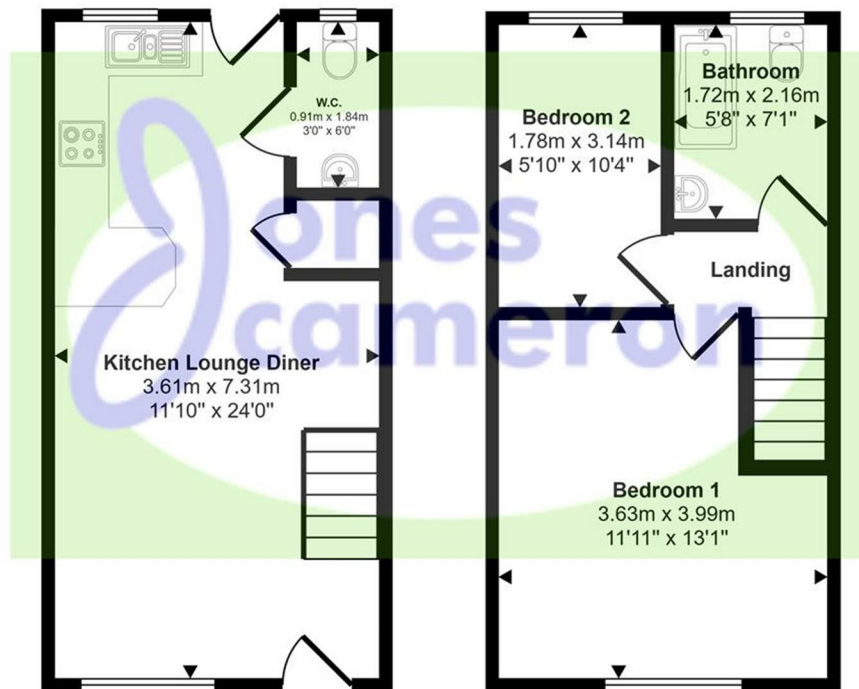

Ground Floor
Approx 26 sq m / 284 sq ft

First Floor
Approx 26 sq m / 285 sq ft

This floorplan is only for illustrative purposes and is not to scale. Measurements of rooms, doors, windows, and any items are approximate